

# SEAWIND 1160

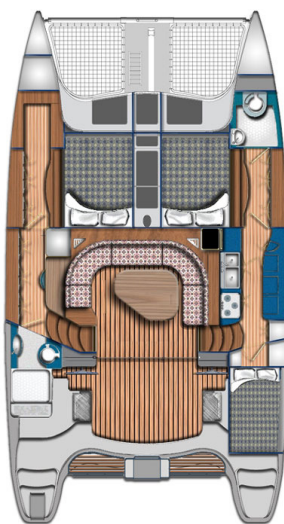

Three Cabin Regular

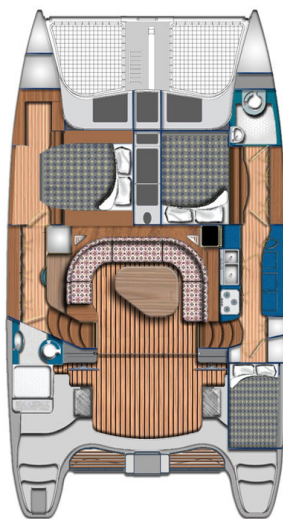

Three Cabin Island Bed  
(Standard)

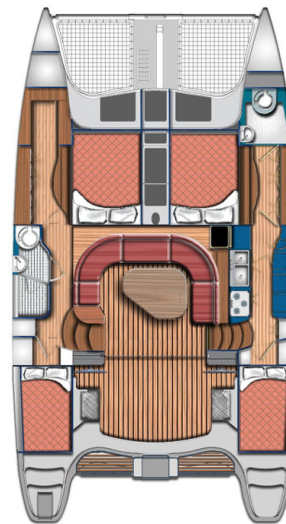

Four Cabin Standard  
(Island Bed Available)

## SPECIFICATIONS

Overall Length	38ft / 11.6m
Waterline Length	37ft / 11.3m
Beam	21'4" / 6.5 m
Draft	3' 7" / 1.1 m
Displacement	15,400lbs / 7 tonnes kgs
Underwing Clearance	2'4" / 0.73m
Steering Twin Helms	Cable Steering
Diesel Sail Drives	2 x 29hp Yanmar
Fuel	95 US gallons / 360 litres
Fresh Water	185 US gallons / 700 litres
Holding Tanks	63 US gallons / 240 litres

**ADDENDUM 1****SEAWIND 1160 (11.60 METRES / 38ft)****STANDARD SPECIFICATIONS AND EQUIPMENT.**

1. **GENERAL:** The overall finish of the Seawind 1160 will be consistent with a luxury world-standard yacht of this size and type. Only very high quality equipment is used throughout.  
The overall aim is for a level of construction, workmanship, equipment, fitout and style that surpasses any other comparable catamaran available in the market at this price range.
2. **EXTERIOR / LAMINATE:**  
Finish: Full female moulded hulls & decks, exterior gelcoat finish with moulded-in non-slip surface on deck areas.  
Hull Laminate: Vinyl Ester (Modified epoxy) resin laminate of the hulls between the gelcoat and the foam core. Polyester resin elsewhere. Laminate specifications are to Australian and International Survey Standards.
3. **MAST/BOOM/SAILS:**
  - Clear anodised aluminium mast and boom. Single Spreader, 7/8 rig.
  - Standing Rigging
    - Forestay 3/8 (10mm) 1 x 19 Dieform wire.
    - Sidestays 3/8 (10mm) 1 x 19 Dieform wire
    - Diamonds 5/16 (8mm) 1 x 19 Dieform wire.
  - All fitted with Sealock turnbuckles and end fittings.
  - Halyards
    - Main halyard: 12 mm Spectra rope : Heavy duty shackle.
    - Genoa halyard: 8 mm Spectra rope. Heavy duty shackle.
    - Topping lift: 10 mm rope, Heavy duty shackle.
    - Spinnaker Halyard: 10mm rope with snap-shackle spliced to end.
  - Boom outhaul.
  - 2 x mainsail single line reefing fitted.
  - All halyards, reefing lines to be lead back to cockpit through turning blocks, rope clutches (Spinlock).
  - Fully battened mainsail. Triple stitched reinforced construction. Leach adjustable batten end caps. Fibreglass sail battens. Roller bearing batten cars.
  - Cruising mainsail cover with integrated lazy jack system.
  - Self-tacking headsail. Profurl headsail furler. Curved headsail traveller track with end stops. Control sheet to cockpit.
4. **DECK EQUIPMENT:**
  - Aluminium Hatches & portholes (9 in total)
    - 4 x Forward Hatches 470mm x 470mm (Gebo)
    - 2 x Mid cabin hatches 470mm x 470mm (Gebo)
    - 1 x Port Bathroom window hatch 507mm x 377mm (Gebo)
    - 1 x Galley window hatch 507mm x 377mm (Gebo)
    - 1 x Aft Cabin window hatch 507mm x 377mm (Gebo)
  - Fibreglass Deck Hatches:
    - Forward anchor & storage hatches x 5
    - Cockpit storage hatches x 2
  - 6 x Docking cleats. Each side : bow, stern & amidships.
  - 1 x Heavy duty mooring cleat on forward walkway.
  - Ventilation: 2 x forward cabin hatch vents.
  - Mast base turning blocks. All halyards & sail controls to cockpit.
  - 12 x Rope clutches - Spinlock brand.
  - Sheet winches : 2 x Harken 46ST - 2 speed self tailing & 2 x Harken 40ST - 2 speed self tailing.
  - Stanchions/Rails: High quality stanchions, bow rails and stern rails with 3 life-lines. 700mm high to meet Australian survey requirements..
  - 2 x transom access gates with pelican hook releases.
  - 2 x side access gates with pelican hook releases.
  - Aft swim ladder : folding stainless aft swim ladder.
5. **FORWARD BEAM, CATWALK AND TRAMPOLINES:**
  - Forward beam section 125 x 3mm. Powder coated white.  
Adjustable pelican striker and cable.
  - 1 x Mooring rollers above foredeck.
  - 2 x Anchor roller under deck. Permanent stowage position for 45lb Plough (CQR type) anchor. (cheeks 75mm high).
  - Catwalk in foam-sandwich fibreglass.
  - Plastic coated open weave trampolines.
6. **AFT BEAM AND DECK:**
  - Moulded fibreglass Targa Bar with curved mainsheet track.
  - Stainless steel framed slatted seats behind aft beam. Fibreglass top table between seats.
  - Stainless steel BBQ.

7. **RUDDER SYSTEM:**
- Twin helm stations : 2 X 32" stainless steel steering wheels.
  - Both wheels independently linked to steering system. - system offers back-up redundancy.
  - Helm seats with ice box under port side and storage under starboard side.
8. **INTERIOR FINISH:**
- Polished beech & beech laminate interior.
  - Sides and cabin top lined with vinyl or moulded gelcoat.
  - Floors : Common area soles simulated teak with holly inlay; Cabin soles carpeted.
9. **SALOON**
- Ornate polished timber dining table: Lowers to create coffee table or double bed.
  - Upholstered settee.
  - Cocktail cabinet with ornate polished hinging lid.
  - Forward opening windows in 10mm toughened glass in marine anodised aluminium frame. Side windows in 6mm toughened glass.
  - Simulated teak & holly flooring.
  - Saloon / cockpit doors: Moulded gelcoat tri-fold doors. Complete with folding mechanism for folding into Targa walkway.
10. **GALLEY**
- Spacious galley with co-ordinated Polystone counter surfaces, timber accents.
  - Three ( 3 ) burner LPG stove & oven. Stainless steel pot holders. Flame failure device to shut off LPG immediately in event of flame going out.
  - Double bowl stainless steel sink.
  - Pressure hot & cold fresh water system. Single lever mixing tap.
  - Refrigerator : Front opening upright "Vitrifrigo" fridge 130 litres.
  - Spacious freezer - large 60 litre top loading, heavily insulated. 12volt Eutectic system by ICEER.
  - Under bench storage with polished timber door fronts & cutlery drawers.
  - Inboard side of galley: Over-bench cupboard with sliding door fronts
  - Simulated teak & holly flooring.
  - Trash bin, paper towel holder.
  - LPG solenoid control in galley
11. **SLEEPING CABINS:**
- Polished timber solid doors on all private cabins.
  - Port & Starboard fwd cabins : Each queen sized bed (2050mm x 1540mm)
  - Aft Starboard cabin : Double bed (1990mm x 1230mm)
  - Mattresses to be 150mm ( 6" ) foam upholstered.
  - Cabins lined.
  - Recessed 12volt lighting.
  - Storage/Cupboards.
  - Carpeted floors.
12. **PORT HEAD :**
- Polished timber solid lockable door.
  - PAR manual toilet. Discharge via holding tank.
  - Holding tanks built in. Discharge Pump out by shore station or directly overboard. Port 130L and Stb 110L.
  - Pipes, skin fittings and sea-cocks are easily accessible and to meet survey requirements.
  - Vanity basin with pressure hot & cold water.
  - Separate shower stall with clear glass door. Wall mounted shower head & mixer tap. Electric shower bilge pump with direct overboard discharge.
  - Large quantity cupboards / shelves to very high quality.
13. **STARBOARD HEAD :**
- Polished timber solid lockable door.
  - PAR manual toilet. Discharge via holding tank.
  - Holding tank built in. Discharge Pump out by shore station or directly overboard.
  - Pipes, skin fittings and seacocks to be easily accessible and to meet survey requirements.
  - Vanity basin with pressure hot & cold water. Shower head and basin mixer tap with electric shower bilge pump.
  - Cupboard/shelves to very high quality.
14. **LIGHTING/ELECTRICAL SYSTEM:**
- High quality DC electrical switch panel with circuit breakers, LED indicator lights and voltage display.
  - Marine grade tinned electrical wiring with extensive use of heat sealed connectors..
  - Batteries x 3 comprising: House System (400 amp hrs) : 2 x 200 amp hr AGM (Absorbed Glass Matt) deep cycle / heavy duty batteries. One engine cranking battery - 700 CCA AGM.
  - 230amp heavy duty isolation switch.
  - 12 V lighting : Numerous 12V interior lamps and courtesy lights throughout including recessed lights in cockpit. Dome lights in cockpit.

- 4 x 12V Outlets.
- Survey approved navigation lights. Port & Starboard mounted on bow rails.
- Deck floodlight mounted on spreaders.
- Mast head anchor / riding light.

**15. PLUMBING / FRESH WATER TANKS:**

- Pressure hot & cold water system. Hot water storage system ( 40 litre / 8.8 gallons) . Hot & cold water to galley and both bathrooms.
- Galley fresh water tap is lever type ( Flickmaster or similar).
- Fresh water tank: 750 litres ( 165 gallons). Remote deck filler.
- Johnson fresh water pump.
- Electric bilge pumps (2) with controls integral with master battery switch panel. Float Switches (2).
- Manual bilge pumps (2) in each hull.
- Bronze through-hull fittings to Australian survey standard.
- PAR manual toilets in each head.
- Port bathroom with separate shower stall. Starboard bathroom with dual purpose faucet & shower.
- Electric sump pump for shower drain.
- 2 x LPG bottles - 4.5kg galvanised.
- Fresh water tank gauge.

**16. ENGINES:**

- Twin Yanmar 30hp saildrive diesel engines. Fresh water cooling, rubber isolation mounts on reinforced fibreglass bed with integral oil drip pan.
- Two bladed folding propellers.
- Dual engine controls at port helm station. Remote electric key start at engine controls.
- Fuel tanks: Total 360 litres (80 gallons) in two survey approved pressure tested aluminium tanks. Fuel gauges fitted.
- Water intakes for engines protected by external strainer. ( 1 per engine)
- Twin primary Racor ( or similar) water separator / fuel filters, secondary engine fuel filters. Engine, fuel tank & fuel line installation to Australian standards to meet offshore survey.
- Console mounted engine instruments with electric tachometers, engine monitoring & warning systems, engine hour meters.

**17. NAVIGATION:**

- Twin steering compasses.
- Raymarine ST60 Tridata : Log, speed, depth.
- Raymarine DSC VHF radio.

**18. ANCHORING / MOORING:**

- Muir Cougar electric anchor winch with chain & gypsy. Located under locker to give clean deck. Primary anchor is 45 lb CQR type with 55 mtrs x 8mm short link galvanised chain.
- Primary anchor is stored in a specially designed anchor roller under the forward beam.
- Anchor winch has foot switch at the winch plus a remote up / down control at the helm station.
- 3 x PVC Inflatable Fenders
- 4 x Mooring lines (each 15 metres x 14mm).

**19. ANTIFOULING / STRIPING:**

- Epoxy barrier coat plus 2 coats of high quality black antifouling bottom paint.
- Seawind 1160 decals on each hull and stern.

**DISCLAIMER :** The Specifications above may change at Seawind Catamaran's discretion.



PH: +61 (0)2 4285 9985 - Fax: +61 (0)2 4285 9984

Email: [info@seawindcats.com](mailto:info@seawindcats.com)

Web: [www.seawindcats.com](http://www.seawindcats.com)

Lot 4 York Road, Bellambi NSW 2518

Australia